

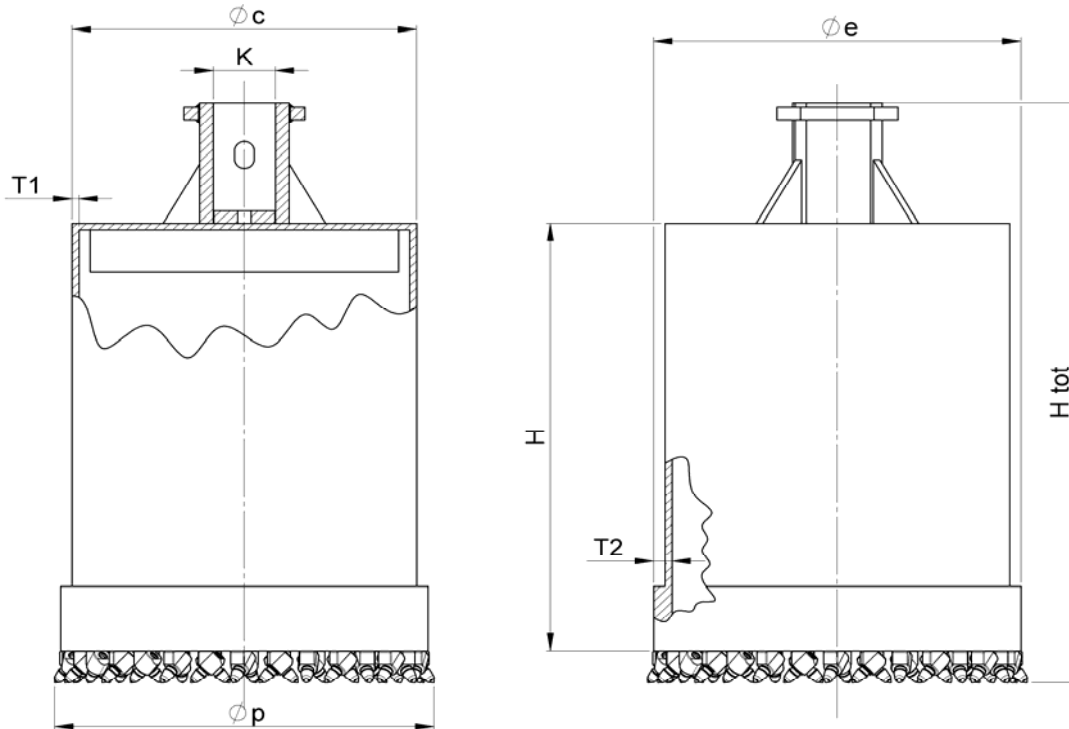

**Carotiere senza scarico**  
**Core barrel without inside flange**

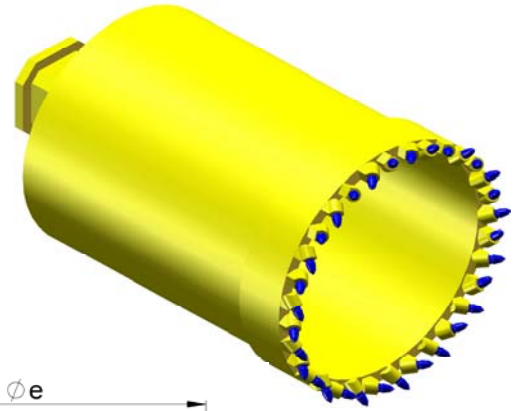

Diametro di perforazione	Diametro esterno	Diametro fusto	Spess. fusto	Sp. anello rinforzo	N° picchi		Altezza fusto	Altezza totale	Lato int. att. quadro	Peso		Codice
Drilling Diameter	Ext. Diam.	Drum Diam.	Drum wall thick.	bottom wall thick.	Number of bullets		Drum Height	Total Height	Kelly Box dimension	Weight		Part Number
Øp (mm)	Øe (mm)	Øc (mm)	T1 (mm)	T2 (mm)	Ø 19,4	Ø 25	H (mm)	H tot (mm)	K (mm)	kg	lbs	
400	350	310	15	30	16	-	1000	1400	130	124	273	OS040-1-31-0
								1400	200	184	405	OS040-2-31-0
							1400	1800	130	173	382	OS040-1-31-4
								1800	200	257	567	OS040-2-31-4
450	400	360	15	30	18	-	1000	1400	130	162	356	OS045-1-31-0
								1400	200	222	489	OS045-2-31-0
							1400	1800	130	226	499	OS045-1-31-4
								1800	200	310	684	OS045-2-31-4
500	450	410	15	30	20	-	1000	1400	130	205	451	OS050-1-31-0
								1400	200	265	583	OS050-2-31-0
							1400	1800	130	286	631	OS050-1-31-4
								1800	200	370	816	OS050-2-31-4
550	500	460	15	30	22	-	1000	1400	130	253	557	OS055-1-31-0
								1400	200	313	689	OS055-2-31-0
							1400	1800	130	354	779	OS055-1-31-4
								1800	200	438	965	OS055-2-31-4
600	550	510	15	30	25	-	1000	1400	130	306	674	OS060-1-31-0
								1400	200	366	806	OS060-2-31-0
							1400	1800	130	428	943	OS060-1-31-4
								1800	200	512	1128	OS060-2-31-4
650	600	560	15	30	27	-	1000	1400	130	364	802	OS065-1-31-0
								1400	200	424	934	OS065-2-31-0
							1400	1800	130	509	1122	OS065-1-31-4
								1800	200	593	1307	OS065-2-31-4

Carandina migliora costantemente i propri prodotti riservandosi il diritto di apportare qualsiasi modifica senza preavviso. - Carandina s.r.l. continually improves its products reserving the right to modify data without warning.

**Carandina produce utensili anche su specifiche del cliente - Carandina s.r.l. produces also drilling tools on customer's demand**

Diametro di perforazione	Diametro esterno	Diametro fusto	Spess. fusto	Sp. anello rinforzo	N° picchi		Altezza fusto	Altezza totale	Lato int. att. quadro	Peso		Codice
Drilling Diameter	Ext. Diam.	Drum Diam.	Drum wall thick.	bottom wall thick.	Number of picks		Drum Height	Total Height	Kelly Box dimension	Weight		Part Number
Øp (mm)	Øe (mm)	Øc (mm)	T1 (mm)	T2 (mm)	Ø 19,4	Ø 25	H (mm)	H tot (mm)	K (mm)	kg	lbs	
700	650	610	15	30	29	-	1000	1400	130	427	941	OS070-1-31-0
									200	487	1073	OS070-2-31-0
							1400	1800	130	597	1317	OS070-1-31-4
									200	681	1502	OS070-2-31-4
750	700	660	15	30	31	-	1000	1400	130	495	1091	OS075-1-31-0
									200	555	1223	OS075-2-31-0
							1400	1800	130	693	1527	OS075-1-31-4
									200	777	1713	OS075-2-31-4
800	750	710	15	30	34	-	1000	1400	130	568	1253	OS080-1-31-0
									200	628	1385	OS080-2-31-0
							1400	1800	130	795	1754	OS080-1-31-4
									200	879	1939	OS080-2-31-4
900	850	810	15	30	38	-	1000	1400	130	730	1609	OS090-1-31-0
									200	790	1741	OS090-2-31-0
							1400	1800	130	1022	2252	OS090-1-31-4
									200	1106	2437	OS090-2-31-4
1000	950	890	20	40	-	30	1000	1400	130	912	2010	OS100-1-42-0
									200	972	2142	OS100-2-42-0
							1400	1800	130	1276	2813	OS100-1-42-4
									200	1360	2999	OS100-2-42-4
1100	1050	990	20	40	-	33	1000	1400	130	1114	2455	OS110-1-42-0
									200	1174	2587	OS110-2-42-0
							1400	1800	130	1559	3437	OS110-1-42-4
									200	1643	3622	OS110-2-42-4
1200	1150	1090	20	40	-	36	1000	1400	130	1336	2945	OS120-1-42-0
									200	1396	3077	OS120-2-42-0
							1400	1800	130	1870	4123	OS120-1-42-4
									200	1954	4308	OS120-2-42-4
1300	1250	1190	20	40	-	39	1000	1400	130	1578	3479	OS130-1-42-0
									200	1638	3611	OS130-2-42-0
							1400	1800	130	2209	4871	OS130-1-42-4
									200	2293	5056	OS130-2-42-4
1400	1350	1290	20	40	-	42	1000	1400	130	1841	4058	OS140-1-42-0
									200	1901	4190	OS140-2-42-0
							1400	1800	130	2577	5681	OS140-1-42-4
									200	2661	5867	OS140-2-42-4
1500	1450	1390	20	40	-	46	1000	1400	130	2124	4682	OS150-1-42-0
									200	2184	4814	OS150-2-42-0
							1400	1800	130	2973	6554	OS150-1-42-4
									200	3057	6739	OS150-2-42-4
1600	1550	1490	20	40	-	49	1000	1400	130	2427	5350	OS160-1-42-0
									200	2487	5482	OS160-2-42-0
							1400	1800	130	3397	7489	OS160-1-42-4
									200	3481	7675	OS160-2-42-4
1700	1650	1590	20	40	-	52	1000	1400	130	2750	6062	OS170-1-42-0
									200	2810	6194	OS170-2-42-0
							1400	1800	130	3850	8487	OS170-1-42-4
									200	3934	8672	OS170-2-42-4
1800	1750	1690	20	40	-	55	1000	1400	130	3093	6819	OS180-1-42-0
									200	3153	6951	OS180-2-42-0
							1400	1800	130	4330	9547	OS180-1-42-4
									200	4414	9732	OS180-2-42-4
1900	1850	1790	20	40	-	58	1000	1400	130	3457	7621	OS190-1-42-0
									200	3517	7753	OS190-2-42-0
							1400	1800	130	4839	10669	OS190-1-42-4
									200	4923	10854	OS190-2-42-4
2000	1950	1890	20	40	-	61	1000	1400	130	3841	8467	OS200-1-42-0
									200	3901	8599	OS200-2-42-0
2200	2150	2090	20	40	-	68	1000	1400	130	4669	10293	OS220-1-42-0
									200	4729	10425	OS220-2-42-0
2500	2450	2390	20	40	-	77	1000	1400	130	6063	13366	OS250-1-42-0
									200	6123	13498	OS250-2-42-0

Carandina migliora costantemente i propri prodotti riservandosi il diritto di apportare qualsiasi modifica senza preavviso. - Carandina s.r.l. continually improves its products reserving the right to modify data without warning.

**Carandina produce utensili anche su specifiche del cliente - Carandina s.r.l. produces also drilling tools on customer's demand**